

OX AIR SHIFTER INSTALLATION

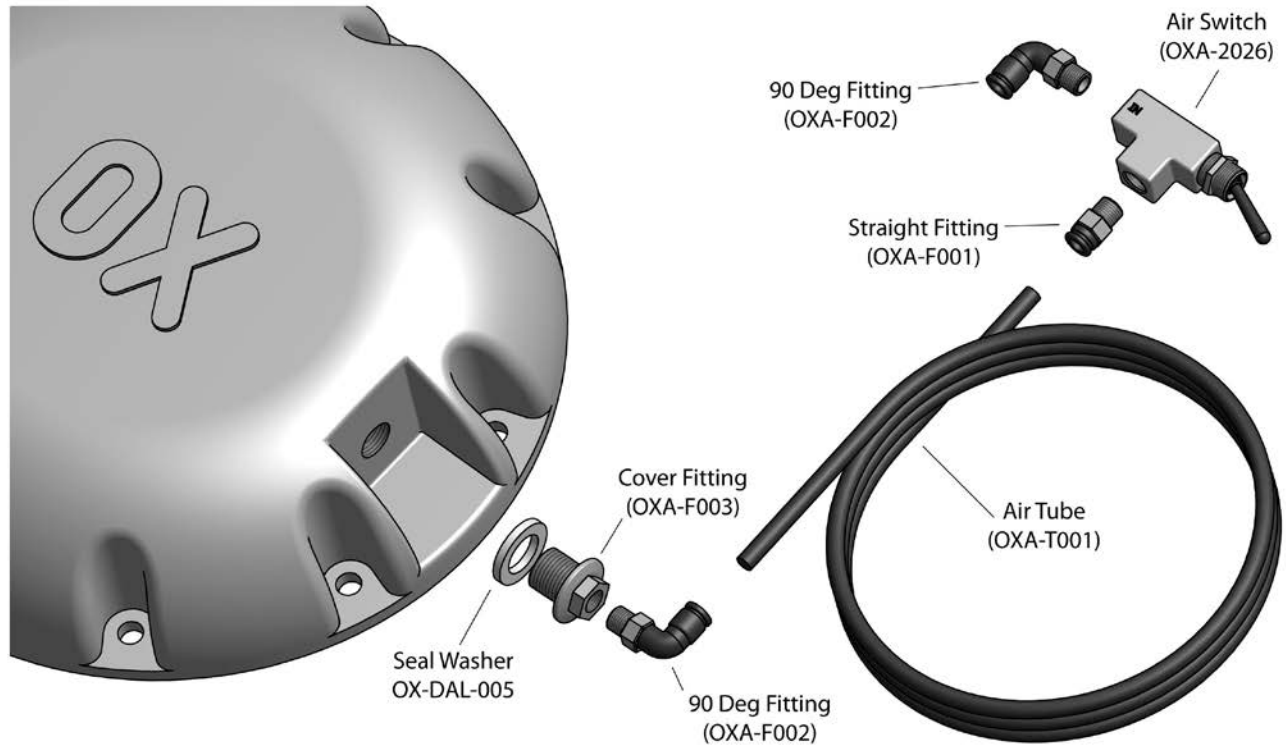

Description and Operation

The air shift system is a pneumatic over mechanical system, using a pneumatic cylinder integrated into the differential cover to mechanically lock the differential. The system requires no adjustment and operates in the 80-120 psi range. Optimum operating pressure is 85 psi.

The system uses a pneumatic switch/valve for control and uses no electricity for reliability purposes. Pneumatic supply systems available from **OX** (sold separately).

Just like all **OX** shifting systems the air shift system can be engaged in motion as long as you are not experiencing wheel spin.

Installation

After **OX** locker and cover is installed per manual:

1. Install cover fitting with seal washer into cover port and tighten to 15 ft. lbs.
2. Determine how you want to route your air line and attach the appropriate air fitting to the cover fitting.
3. Install the appropriate air fittings for your routing plan to the air switch/valve and mount switch to vehicle in desired location. Use 15/64 hole for switch.
4. Route air line from switch to cover and securely push tubing into fittings. When routing pay close attention to chaffing, suspension travel, possible trail hazards and keep away from heat sources.
5. Connect your 80 to 120 psi air source to switch and leak check system all fittings.